

# AMY'S FUND 5K Fleuhr Park Philadelphia, PA

## ELEVATIONS:

START: 26 FT.  
FINISH: 27 FT.  
HIGHEST: 68 FT.  
LOWEST: 26 FT.

COURSE REQUIRES TWO COMPLETE LOOPS PLUS A THIRD TRIP UP THE WALKWAY AFTER PASSING THE START AFTER THE SECOND FULL LOOP, THEN GOING COUNTERCLOCKWISE AROUND THE SOUTH BOLLARD TO PASS MILE 3 AND FINISH DOWN FLEUHR PARK RD.

**USATF / RRTC  
Certification Code  
PA 06006 WB**

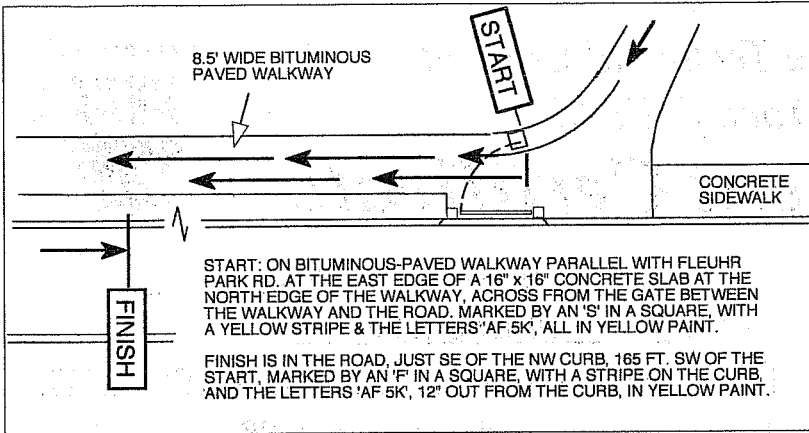

**MILE 1:** (DURING FIRST OF TWO LOOPS) LOCATED ON THE PAVED WALKWAY, 156 FT. NORTHWEST OF THE INTERSECTION WITH THE WALKWAY FROM THE PARKING LOT, AND BEING EVEN WITH A LONE TREE LOCATED ABOUT 20 FT. NORTHEAST OF THE PATH. THE TREE HAS A YELLOW STRIPE PAINTED ON ITS TRUNK. MILE 1 IS MARKED WITH A '1' IN A SQUARE, A STRIPE, AND THE LETTERS 'AF 5K' IN THE WALKWAY, ALL IN YELLOW PAINT

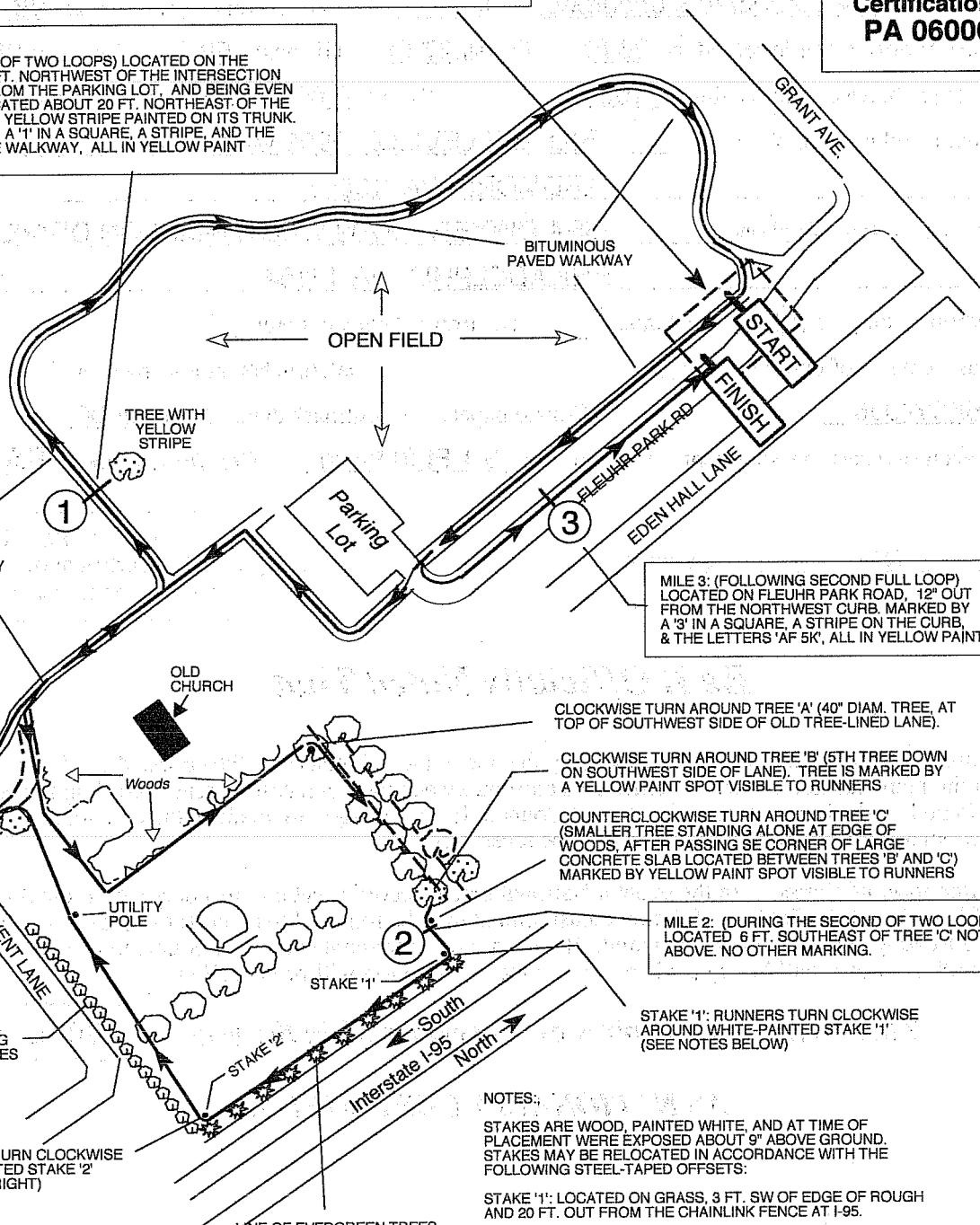
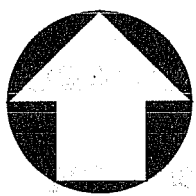

**MILE 3:** (FOLLOWING SECOND FULL LOOP) LOCATED ON FLEUHR PARK ROAD, 12" OUT FROM THE NORTHWEST CURB, MARKED BY A '3' IN A SQUARE, A STRIPE ON THE CURB, & THE LETTERS 'AF 5K', ALL IN YELLOW PAINT.

COURSE TURNS CLOCKWISE AROUND LONE 20" DIA. FIR TREE

CLOCKWISE TURN AROUND TREE 'A' (40" DIAM. TREE, AT TOP OF SOUTHWEST SIDE OF OLD TREE-LINED LANE).

CLOCKWISE TURN AROUND TREE 'B' (5TH TREE DOWN ON SOUTHWEST SIDE OF LANE). TREE IS MARKED BY A YELLOW PAINT SPOT VISIBLE TO RUNNERS

COUNTERCLOCKWISE TURN AROUND TREE 'C' (SMALLER TREE STANDING ALONE AT EDGE OF WOODS, AFTER PASSING SE CORNER OF LARGE CONCRETE SLAB LOCATED BETWEEN TREES 'B' AND 'C') MARKED BY YELLOW PAINT SPOT VISIBLE TO RUNNERS

**MILE 2:** (DURING THE SECOND OF TWO LOOPS) LOCATED 6 FT. SOUTHEAST OF TREE 'C' NOTED ABOVE. NO OTHER MARKING.

COURSE TURNS COUNTERCLOCKWISE AROUND CLUMP OF BRUSH

STAKE '1': RUNNERS TURN CLOCKWISE AROUND WHITE-PAINTED STAKE '1' (SEE NOTES BELOW)

STAKE '2': RUNNERS TURN CLOCKWISE AROUND WHITE-PAINTED STAKE '2' (SEE NOTES LOWER RIGHT)

**NOTES:**

STAKES ARE WOOD, PAINTED WHITE, AND AT TIME OF PLACEMENT WERE EXPOSED ABOUT 9" ABOVE GROUND. STAKES MAY BE RELOCATED IN ACCORDANCE WITH THE FOLLOWING STEEL-TAPED OFFSETS:

STAKE '1': LOCATED ON GRASS, 3 FT. SW OF EDGE OF ROUGH AND 20 FT. OUT FROM THE CHAINLINK FENCE AT I-95.

STAKE '2': LOCATED ON GRASS, 32 FT. NW OF CHAINLINK FENCE AND 16 FT. NE OF CENTERLINE OF ROW OF SMALL TREES ON THE NE SIDE OF CONVENT LANE.